

CHOSEN

VENT TECH LTD.



PRODUCTS

- Axial Fan
- Centrifugal Fan
- Fan Accessories
- Mist Spray Fan
- Evaporative Air Cooler
- Hydroponic(Inline) Duct Fan
- Exhaust Fan
- Cooling Pad



CHOSEN

VENT TECH LTD. Company Profile

CHOSEN VENT TECH LTD. is a manufacturer who focus on the design and producing for the industrial & commercial ventilators. Our ventilators be use in ventilation system (supply or exhaust) of Building, Air-conditioning, Industrial (HVAC), Firefighting, the commercial & industrial (HVAC) system.

We have products ranges include completed fans & fan accessories. The fans include forward-curve & backward-curve centrifugal fans (Blowers), axial fans, misting fans. The accessories include forward-curve & backward-curve impellers, axial impellers, fan blades and so on. We are not only manufacture products for standard item with bulk quantity, but also we provide project solution and fan type selection. Custom, semi-custom, OEM, ODM also our advantages.

Our engineers who with more than 20years experience in fans design, with the help of the advanced processing equipments (Laser cuttings, CNC lathers & bendings, Rolling, Dynamic balance) and experienced workers, they ensure the fans with high quality. And the fans be test by airway system so their technical parameters are truth & reliable.

Currently, our products have been exported to more than 30countries, and win trust & affirmation of the clients.

We CHOSEN VENT TECH LTD will be your honest and reliable partner.

FORWARD CENTRIFUGAL FAN (SK-D)



Forward Curved Centrifugal Fan (SK-D Series)		
Technical Specification		
Impeller Dia Range Ø	mm	200 ~ 450
Air flow	CMH	700 ~ 20200
Air pressure	Pa	76 ~ 713
Electric Option	V/HA/Phase	220V/380V/420V
		50HZ/60HZ
		Single phase / 3 phase
Power Option	KW	0.18 ~ 7.5
Motor Grade	Protection	IP54
	Insulation	F, B
Material Option	Fan housing Frame	Galvanized
		#304 S.S., #316 S.S., #316L S.S.
	Fan impeller	Galvanized
		#304 S.S., #316 S.S., #316L S.S.
Driven Option		Direct (A)
Function Option	Popular	For normal usage situation
	Explosion	
	Firefighting	
Customizable		

Applications:

For ventilation (supply or exhaust) system and industrial(HVAC) applications such as industrial plants, machinery manufacturing, chemical, printing and dyeing, electroplating, medicine and other industries, theaters, hotels, office buildings, residential buildings and other buildings.

Advantages:

- ⊙ The Fan with advantages of light weight, low power consumption, low noise, corrosion resistance and long service life.
- ⊙ It can also supply vibration-reducing pedestal or steel frame.
- ⊙ The fan is well-made and has different types of specifications for users to choose.





Performance Data

Item	Impeller Dia	Speed	Power	Air Flow	Total Pressure	Weight
	mm	rpm	Kw	CMH	Pa	Kg
CH-SK200D	200	950	0.18	700-1500	117-76	13
		1350	0.25	1096-1592	227-145	13
CH-SK230D1	230	950	0.32	1412-2200	294-273	14
CH-SK230D2	230	950	0.18	1500-2100	170-140	14
		1350	0.32	1700-2500	295-270	14
			0.37	1700-2700	390-367	15
CH-SK250D1	250	950	0.25	1699-2500	181-131	15
		1350	0.55	2000-3100	309-220	19
			0.55	1922-3075	409-314	19
CH-SK250D2	250	950	0.32	1697-2800	184-110	16
		1350	0.55	2800-3350	340-290	19
			0.75	1960-4000	357-245	22
CH-SK250D3	250	950	0.37	2100-3200	182-127	18
		1350	0.75	2838-4112	325-214	22
			0.75	3000-4000	384-335	22
CH-SK280D1	280	950	0.37	2000-3000	240-190	18
		1350	1	2400-5000	544-430	22
CH-SK280D2	280	950	0.45	1400-3500	247-188	20
		1350	1.1	2400-5400	507-425	35
CH-SK280D3	280	950	0.55	2400-4300	209-146	22
		1350	1.5	3390-6200	507-425	40
CH-SK320D1	320	950	0.75	2300-4700	374-320	25
		1350	1.8	3000-6500	662-585	44
CH-SK320D2	320	950	1.1	2700-5100	310-200	43
		1350	2.2	4000-7200	616-507	47
CH-SK380D	380	950	2.2	5500-8100	490-466	62
CH-SK400D1	400	1350	2.2	6000-8600	564-539	62
CH-SK400D2	400	950	3	5200-12000	515-430	78
CH-SK450D1	450	950	4	9468-12580	713-685	91
CH-SK450D2	450	950	5.5	11482-16200	714-680	114
CH-SK450D3	450	950	7.5	13210-20200	705-634	134

FORWARD CENTRIFUGAL FAN (SK-S)



Forward Curved Centrifugal Fan (SK-S Series)		
Technical Specification		
Impeller Dia Range Ø	mm	200 ~ 500
Air flow	CMH	502 ~ 24840
Air pressure	Pa	120 ~ 850
Electric Option	V/HA/Phase	220V/380V/420V
		50HZ/60HZ
		Single phase / 3 phase
Power Option	KW	0.18 ~ 11
Motor Grade	Protection	IP54
	Insulation	F, B
Material Option	Fan housing Frame	Galvanized
		#304 S.S., #316 S.S., #316L S.S.
	Fan impeller	Galvanized
		#304 S.S., #316 S.S., #316L S.S.
Driven Option		Direct (A)
Function Option	Popular	For normal usage situation
	Explosion	
	Firefighting	
Customizable		

Applications:

For ventilation (supply or exhaust) system and industrial(HVAC) applications such as industrial plants, machinery manufacturing, chemical, printing and dyeing, electroplating, medicine and other industries, theaters, hotels, office buildings, residential buildings and other buildings.

Advantages:

- ⊙ The Fan with advantages of light weight, low power consumption, low noise, corrosion resistance and long service life.
- ⊙ It can also supply vibration-reducing pedestal or steel frame.
- ⊙ The fan is well-made and has different types of specifications for users to choose.



Performance Data

Item	Impeller Dia	Speed	Power	Air Flow	Total Pressure	Weight
	mm	rpm	Kw	CMH	Pa	Kg
CH-SK200S	200	950	0.18	502-1186	154-120	13
		1350	0.25	701-1400	275-200	13
CH-SK230S	230	950	0.18	1600-2300	185-160	15
		1350	0.32	1490-2600	319-305	15
			0.37	1400-2600	434-400	17
CH-SK250S1	250	950	0.25	897-2000	210-190	15
		1350	0.32	1400-2300	447-427	16
			0.45	1700-2600	474-428	16
CH-SK250S2	250	950	0.25	1700-2300	211-191	16
		1350	0.45	2100-3000	421-387	19
			0.55	1600-3300	451-417	20
CH-SK250S3	250	950	0.32	1900-2700	215-204	17
		1350	0.55	2550-3400	383-317	21
			0.75	2200-4000	457-365	23
CH-SK280S	280	950	0.37	1500-2800	304-275	19
		1350	0.75	2000-3870	581-495	23
CH-SK300S1	300	950	0.55	2100-3500	360-340	23
		1350	1.5	2690-5400	680-585	41
CH-SK300S2	300	950	0.75	2000-4200	375-335	26
		1350	1.8	3000-6000	692-611	44
CH-SK320S	320	950	0.75	2400-4200	404-375	26
		1350	2.2	4000-6300	731-705	46
CH-SK350S1	350	1350	2.2	4000-6270	778-710	50
CH-SK350S2	350	1350	3	4720-7250	707-695	58
CH-SK380S	380	950	1.8	3900-6100	503-450	59
CH-SK400S1	400	950	1.8	5481-6700	565-554	61
CH-SK400S2	400	950	3	6500-10800	611-580	85
CH-SK450S1	450	950	4	9600-12100	812-792	97
CH-SK450S2	450	950	5.5	11000-16000	820-771	101
CH-SK500S1	500	950	7.5	14448-22000	860-768	160
CH-SK500S2	500	950	11	18000-24840	860-800	194

PRODUCT SIZE

► SK-D SERIES

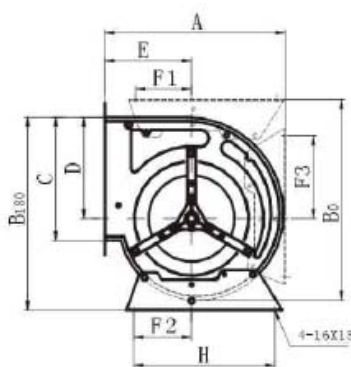

figure 1

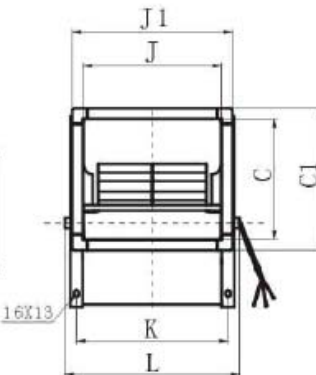
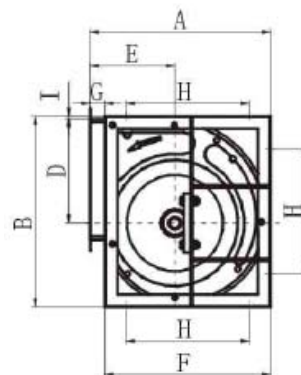

figure 2

Refer to figure 1

Unit: mm

Item	A	B180	B0	C	C1	J	J1	K	H	D	E	F1	F2	F3
CH-SK200D	329	329	329	228	288	232	292	262	170	186	163	85	85	85
CH-SK230D1	366	375	373	256	316	232	292	262	200	216	180	100	100	100
CH-SK230D2	366	375	373	256	316	287	347	317	200	216	180	100	100	100
CH-SK250D1	384	392	427	262	322	275	335	305	300	215	185	119	123	176
CH-SK250D2	384	392	427	262	322	298	358	328	300	215	185	119	123	176
CH-SK250D3	384	392	427	262	322	340	400	370	300	215	185	119	123	176
CH-SK280D1	430	448	483	289	349	270	330	300	340	249	203	136	135	208
CH-SK280D2	430	448	483	289	349	331	391	361	340	249	203	136	135	208
CH-SK280D3	430	448	483	289	349	370	430	400	340	249	203	136	135	208

Refer to figure 2

Unit: mm

Item	A	B	L	C	C1	J	J1	K	H	F	D	E	G	I
CH-SK320D1	497	533	389	341	401	309	369	349	340	461	295	230	36	5
CH-SK320D2	497	533	400	341	401	320	380	360	340	461	295	230	36	5
CH-SK380D	575	621	453	404	464	373	433	413	430	539	342	264	36	5
CH-SK400D1	575	621	453	404	464	373	433	413	430	539	342	264	35	5
CH-SK400D2	575	621	551	404	464	471	531	511	430	539	342	264	35	5
CH-SK450D1	690	751	510	478	538	430	490	470	540	654	415	314	36	7
CH-SK450D2	690	751	637	478	538	557	617	597	540	654	415	314	36	7
CH-SK450D3	690	751	700	478	538	620	680	660	540	654	415	314	36	7

PRODUCT SIZE

SK-S SERIES

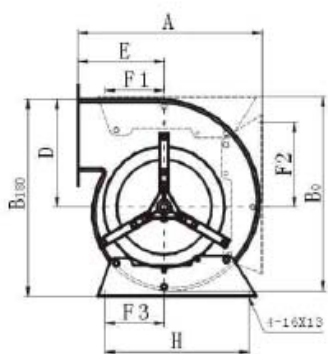

figure 3

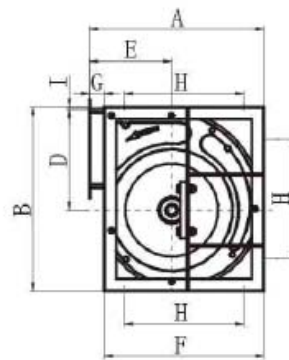
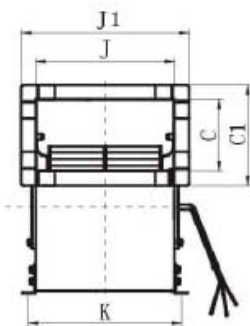
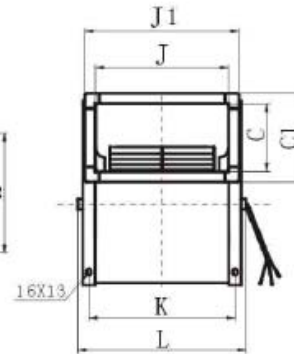

figure 4



Refer to figure 3

Unit: mm

Item	A	B180	B0	C	C1	J	J1	K	H	D	E	F1	F2	F3
CH-SK200S	319	323	323	124	184	232	292	262	170	180	153	85	85	85
CH-SK230S	358	365	365	150	210	300	360	330	200	198	173	100	100	100
CH-SK250S1	385	405	405	150	210	250	310	280	300	225	180	123	123	177
CH-SK250S2	385	405	405	150	210	290	350	320	300	225	180	123	123	177
CH-SK250S3	385	405	405	150	210	340	400	370	300	225	180	123	123	177
CH-SK280S	431	453	453	180	240	270	330	300	300	252	203	123	123	177
CH-SK300S1	472	480	480	182	242	298	358	328	340	264	231	135	135	205
CH-SK300S2	472	480	480	182	242	370	430	400	340	264	234	135	135	205
CH-SK320S	472	480	480	182	242	320	380	350	340	264	231	135	135	205

Refer to figure 4

Unit: mm

Item	A	B	L	C	C1	J	J1	K	H	F	D	E	G	I
CH-SK300S1	466	485	378	182	242	298	358	330	270	436	264	231	36	5
CH-SK300S2	466	485	450	182	242	370	430	402	270	436	264	231	36	5
CH-SK320S	472	482	400	182	242	320	380	360	340	436	264	231	36	5
CH-SK350S1	541	578	400	205	265	320	380	360	340	505	320	252	36	5
CH-SK350S2	541	578	400	205	265	320	380	360	340	505	320	252	36	5
CH-SK380S	609	632	453	240	300	373	433	413	430	564	342	294	45	5
CH-SK400S1	609	632	510	240	300	430	490	470	430	564	342	294	45	5
CH-SK400S2	609	632	621	240	300	541	601	581	430	564	642	294	45	5
CH-SK450S1	719	754	637	240	300	557	617	597	540	664	416	342	58	6
CH-SK450S2	719	754	700	240	300	620	680	660	540	661	416	342	58	6
CH-SK500S1	793	831	720	300	360	620	680	670	600	735	458	378	58	7
CH-SK500S2	793	831	774	300	360	674	734	724	600	735	458	378	58	7

Blank lined area for notes or calculations.



If you need more detailed product parameters, please contact us.

+86-757-27888568



info@ch-ventilation.com

Large grid area for calculations or technical drawings.



CHOSEN VENT TECH LTD.

Address : No.201-1 of 22, International Woodworking Machinery Area, Licun
Lunjiao, Shunde District, Foshan City, Guangdong, China

Production Base : 102 No.5 west of Xianchongzhongxin Road, Qiaonan Street,
Panyu District, Guangzhou, China

Tel : +86-757-27888568

Fax : +86-757-27888568

E-mail : info@ch-ventilation.com

Website : www.ch-ventilation.com