



TILE STRONG ADHESIVE

This product is a single component green eco-friendly polymer products, easy-to-use, superior penetration, excellent adhesion, excellent bonding performance, waterproof and anti-aging, no immersion tiles, tiling the wall, permanent solid combination, not hollowing, never fall off.

TECHNICAL DATA

Product Name:	TILE STRONG ADHESIVE
Product Code:	S99
Type:	Water-based acrylic emulsion
Appearance:	Liquid material+Powder
Main Components:	Acrylic emulsion
Color:	White
Finish:	Transparent
Volume:	5 KG/bucket
Brushing Area:	15m ² /kg
Solid Content:	0.543
Ultimate Drawing Force:	1.2 MPa
Bonding Strength:	Normal: 1.8MPa
	After soaking: 1.5MPa
	After thermal ageing: 1.0MPa
	After freeze-thaw cycle:
Product Standard:	JC/T 547-2005(C2)
Service Life:	36 years
Shelf Life:	18 months
Drying Time:	0.5 hours

Application:

Low water-absorption vetrified tiles, rustic tiles, marbles, tiles pasting onto the wall /tiles /steels /plywood /glass

Advantages:

- ◆ Strong penetration
 - ◆ Strong adhesion
 - ◆ Waterproof and anti-aging
 - ◆ High temperature and freeze-thaw resistance
-

Application Conditions/ Limitations:

Surface preparation Clean the dust/ water / release agent

Construction Temperature: 5°C~45°C.

Construction Humidity ≤85%

Dew Point: ◆ Beware of condensation!

◆ Substrate temperature during application must be at least 5°C above dew point.

GUANGDONG SHILIDE BUILDING MATERIAL CO. LTD.

#27-33, Floor 3rd , Block 6, Meiju Building Materials City, Lvjing West Road, Foshan, Guangdong, China
Ph: +86 0757 82726219 Email: exp@shilide.com.cn Website: www.shilide.com.cn

Storage condition 18 months from date of production if stored properly in original unopened, sealed and undamaged packaging in cool and dry conditions at temperatures between +5°C and +25°C. Protect from direct sunlight.

Application Instructions:

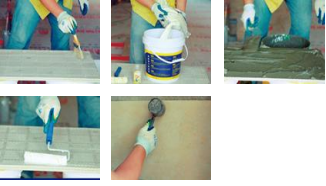

1. Clean up the water and dust.
 2. Open the cover of the bucket and pour out the tile adhesive.
 3. Roll on the back of the tiles evenly.
 4. Use the cement mortar to pasting directly after 30 minutes drying.
 5. Pasting the tiles and fine-tuning possible within 20 minutes
-

Safety health & Environmental information

During painting Always work in a well ventilated area. Wear appropriate attire, especially gloves and eye protection gear. Avoid contact with skin as it may cause irritation.

Cleaning Wash all the tools with water immediately after application

Safety instructions In case of eye contact, rinse immediately with water and seek immediate medical treatment. To remove paint for skin, use soap and water or appropriate cleanser. In the event of spillage, contain and collect spilt paint by using sand or earth.

Environment: Does not contain any added lead, mercury or chromium compounds.

GUANGDONG SHILIDE BUILDING MATERIAL CO. LTD.

#27-33, Floor 3rd , Block 6, Meiju Building Materials City, Lvjing West Road, Foshan, Guangdong, China
Ph: +86 0757 82726219 Email: exp@shilide.com.cn Website: www.shilide.com.cn